

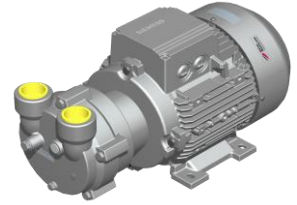

**Elmo
Rietschle**

IE2



L-BV

Data sheet 2BV7 071

Liquid ring compressor

General information

Elmo Rietschle compressors of the model range L-BV7 are suitable for compressing gases and wet vapours.

Our pumps have stainless steel shafts which makes them corrosion resistant. They work safely and reliably even under extreme conditions, like those in humid processes.



Performance curves

Compressor operation

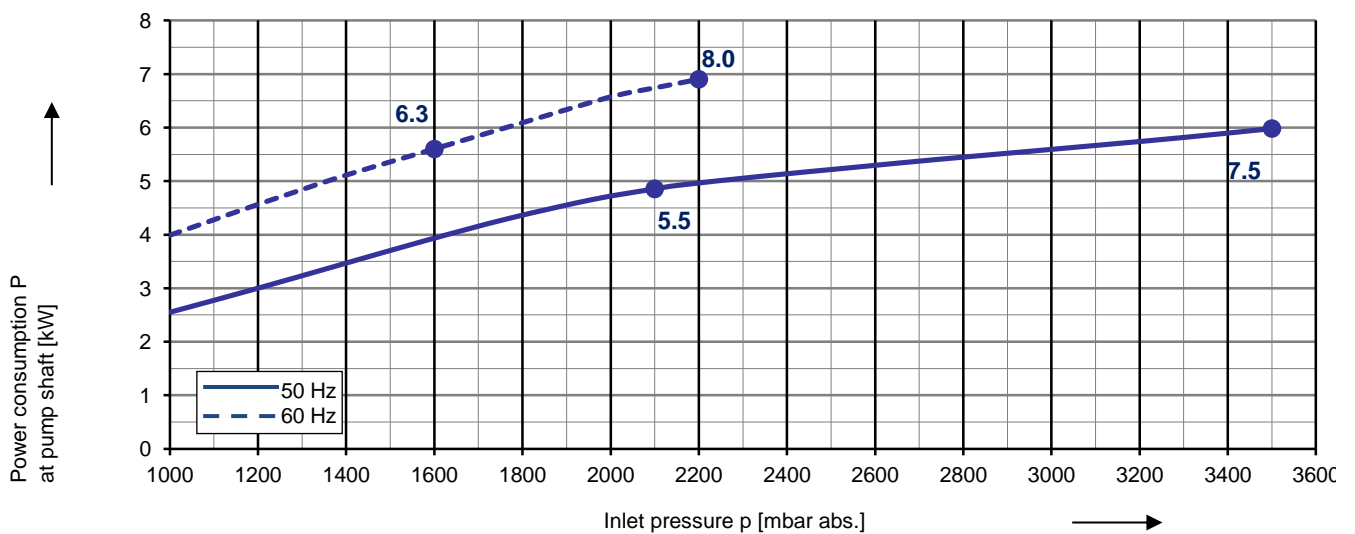
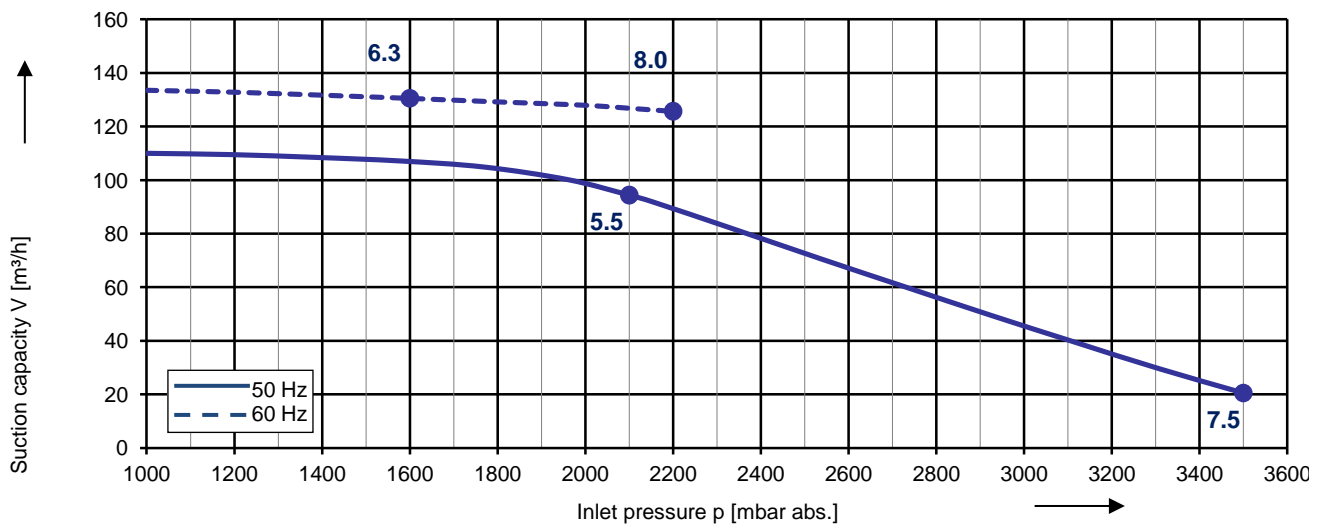

The characteristic curves are based on the evacuation of 100 % saturated air and an intake temperature of 20 °C. At a suction pressure of 1013 mbar abs. and a temperature of the operating liquid of 15 °C (water as operating liquid) the characteristic curve

The motors are supplied as standard for the input voltage ranges of 50 and 60 Hz and for the protection category IP55 as well as as approved for UL and CSA.